

27th STREET

1. All work embodied on these plans shall be done in conformity with applicable provisions of Specifications W-2271.
2. 8" x 4" Manholes with connecting sewer to be constructed on shown in plan (MS-87).
3. All verified city pipe base connections shall be constructed on an upward grade of 2% from main sewer to the property line.
4. All house connections are approximate and exact locations shall be determined in the field.

ETCH MARK
Screw of SW Corner Highway Ave
and Waterman Ave
EN 17253 MSL.


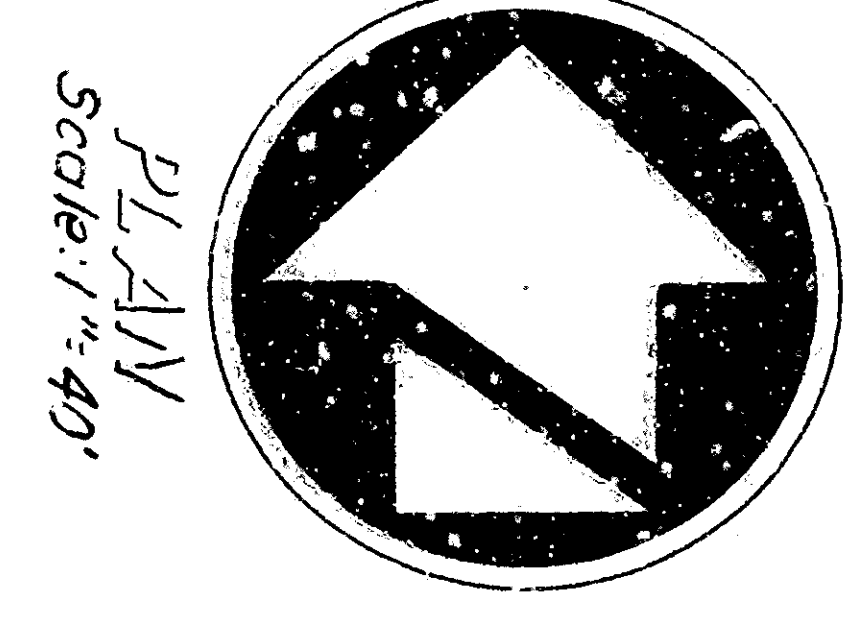


NO.	DATE	BY	CHKD.	APPROVED
1	12/21/88	CLC	Dec 21, 1988	Approved
2	1/15/89	BT	1/15/89	Approved

SUBMITTED BY: *Blagoje S. Jovanovic*
 APPROVED: *Blagoje S. Jovanovic*
 CITY OF SAN BERN
 WATERMAN AVENUE
 23rd STREET to 27th STREET
 SEWER
 2382